

Kingswood Center - For Lease

Class A Office Space For Lease

Brooklyn, NY 11229 - Midwood



Office Leasing

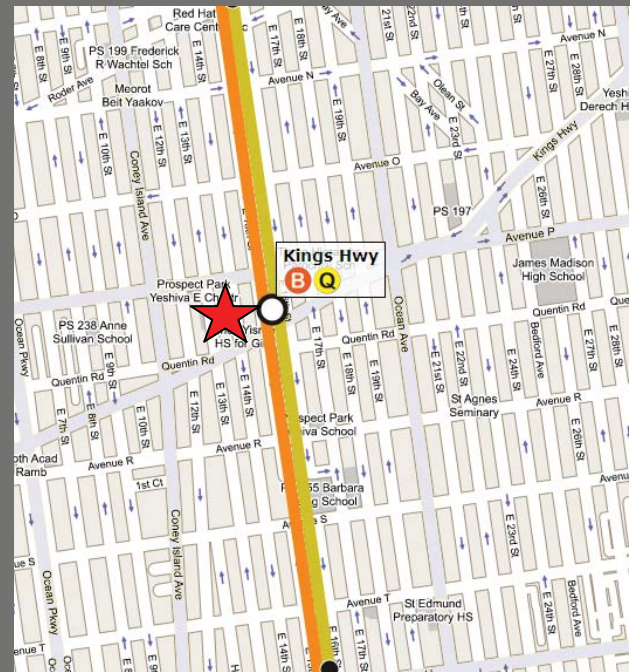

Address: 1630 E. 15th Street
Cross Streets: Between Kings Hwy & Avenue P
2nd Floor: 2,500 - 25,000 SF
Parking: 300 +/- spaces on-site
Zoning: C4-6
CAM: \$2.50 PSF
Insurance: \$0.50 PSF
RE Taxes: \$1.20 PSF +/- (ICIP Abatement)
Rent: \$28 - 32 PSF

TRANSPORTATION

B **Q** 1/2 block at Kings Hwy station
Area serviced by 5 bus lines including: B82, B100, B68, B2, B31
16,000 avg. daily subway transfers (5.8 million annually)

NEIGHBORING TENANTS

Visiting Nurse Service, New York Sports Club, Duane Reade, HSBC, Citibank, Apple Bank, Bank of America, Steve Madden, Nine West, The Children's Place, Sleepy's, Dunkin Donuts.

FEATURES

- Can provide up to 60,000 SF of additional space on upper floors
- Outstanding demographics
- Steps to Kings Highway amenities including restaurants, shopping, banking, and more

For Further Information, Please Contact Exclusive Leasing Team:

Timothy D. King
Principal
tking@cpexre.com

Ryan P. Condren
Associate Director
rcondren@cpexre.com

Eric G. Altschul
Associate Director
ealtschul@cpexre.com

WWW.CPEXRE.COM

CPEX Real Estate | 350 Livingston St, 1st Fl, Brooklyn, NY 11217 | Tel: (718) 935-1800 | Fax: (718) 935-1822

All information contained herein was provided by or obtained from the owner of the property or from sources that we deem reliable. Though we have no reason to doubt the validity of the information, we do not warrant any information disclosed. All measurements of area and dimensions, zoning and uses must be independently verified. IT IS STRONGLY URGED THAT THE PROSPECTIVE TENANT CAREFULLY VERIFY EACH ITEM OF SIZE, RE TAXES, PERMITTED LEGAL USE AND ALL OTHER INFORMATION HEREIN.

Kingswood Center - For Lease

Class A Office Space For Lease - 2nd Floor Plan

Brooklyn, NY 11229 - Midwood



Office Leasing

EAST 15TH STREET

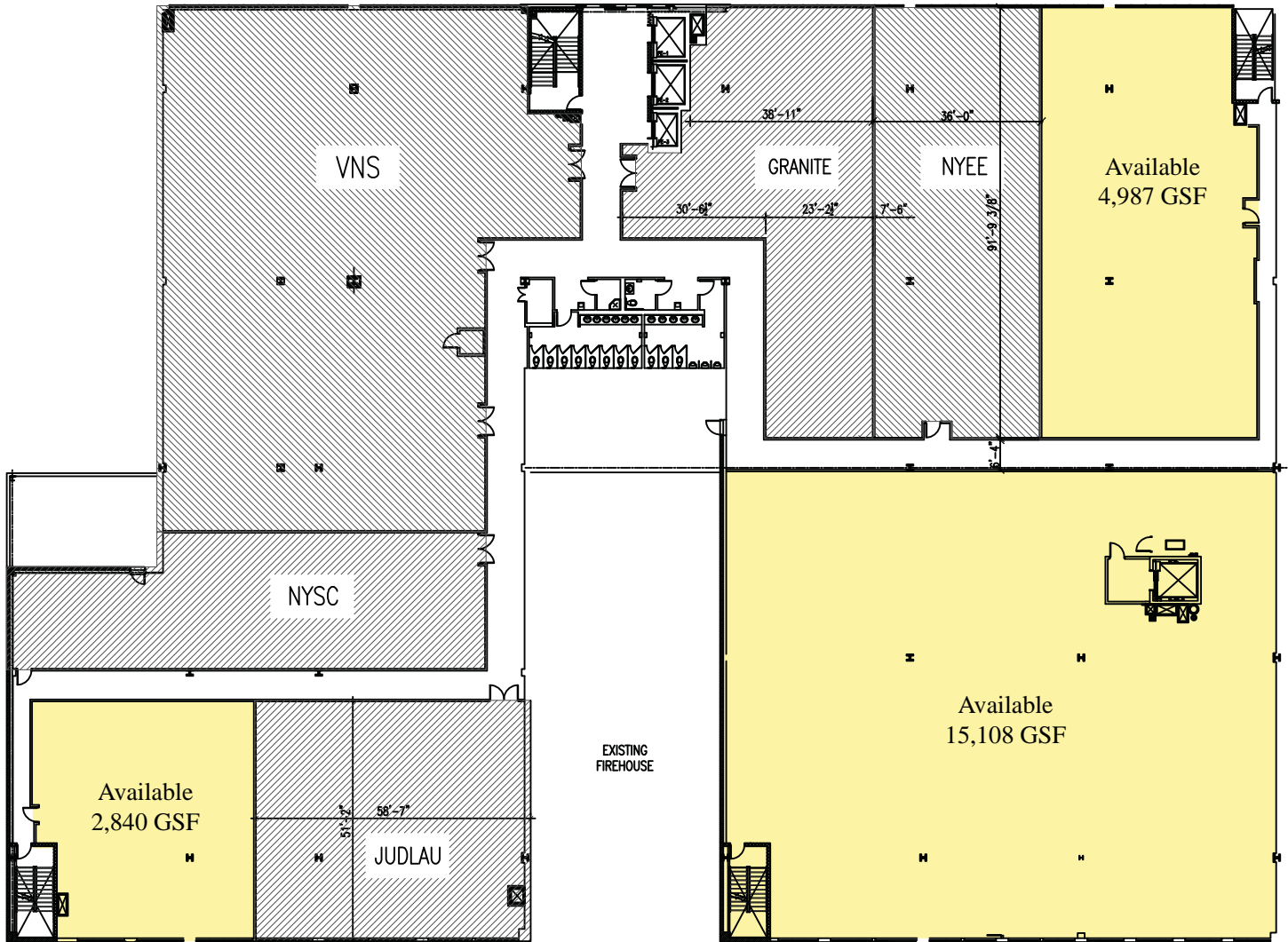

EAST 14TH STREET

For Further Information, Please Contact Exclusive Leasing Team:

Timothy D. King
Principal
tking@cpexre.com

Ryan P. Condren
Associate Director
rcondren@cpexre.com

Eric G. Altschul
Associate Director
ealtschul@cpexre.com

WWW.CPEXRE.COM

CPEX Real Estate | 350 Livingston St, 1st Fl, Brooklyn, NY 11217 | Tel: (718) 935-1800 | Fax: (718) 935-1822

All information contained herein was provided by or obtained from the owner of the property or from sources that we deem reliable. Though we have no reason to doubt the validity of the information, we do not warrant any information disclosed. All measurements of area and dimensions, zoning and uses must be independently verified. IT IS STRONGLY URGED THAT THE PROSPECTIVE TENANT CAREFULLY VERIFY EACH ITEM OF SIZE, RE TAXES, PERMITTED LEGAL USE AND ALL OTHER INFORMATION HEREIN.