

774 Rockaway Avenue

Brooklyn, NY 11212 - Brownsville

Retail Space For Lease



Retail Leasing

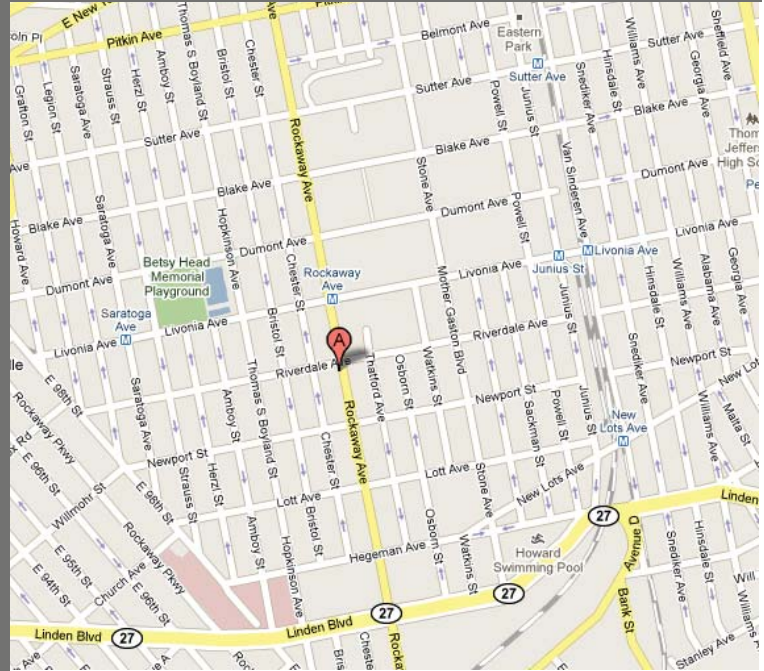

Location: SW Corner of Riverdale Ave

Retail 1: 3,485 SF (approx.)

Retail 2: 3,602 SF (approx.)

Retail 3: 1,377 SF (approx.)

Retail 4: 1,222 SF (approx.)

Total: 9,686 SF (approx.)

Community-Use Space: 2,084 SF

Frontage: 140 FT

Zoning: C2-3/R6

Asking Rent: \$15-20 PSF

TRANSPORTATION

3 train at Rockaway Ave located 1 block away
B60 servicing Rockaway Ave
Over 1.8 million subway transfers annually

NEIGHBORING TENANTS

Key Food, Giant Laundry, Family Dollar, Popeyes,
Associated Supermarket, Pay-o-Matic

FEATURES

- Just one block from the train
- Corner of two 2-way streets with 4-way traffic signal
- New Construction allows for flexible layouts

For Further Information, Please Contact Exclusive Agents:

Timothy D. King
Principal
tking@cpxre.com

Eric G. Altschul
Associate Director
ealtschul@cpxre.com

Ryan P. Condren
Associate Director
rcondren@cpxre.com

WWW.CPEXRE.COM

CPEX Real Estate | 350 Livingston Street, 1st Fl, Brooklyn NY 11217 | Tel: (718) 935-1800 | Fax: (718) 935-1822

All information contained herein was provided by or obtained from the owner of the property or from sources that we deem reliable. Though we have no reason to doubt the validity of the information, we do not warrant any information disclosed. All measurements of area and dimensions, zoning and uses must be independently verified. IT IS STRONGLY URGED THAT THE PROSPECTIVE TENANT CAREFULLY VERIFY EACH ITEM OF SIZE, RE TAXES, PERMITTED LEGAL USE AND ALL OTHER INFORMATION HEREIN.

774 Rockaway Avenue

Brooklyn, NY 11212 - Brownsville

Retail Space For Lease - Floor Plan



Retail Leasing

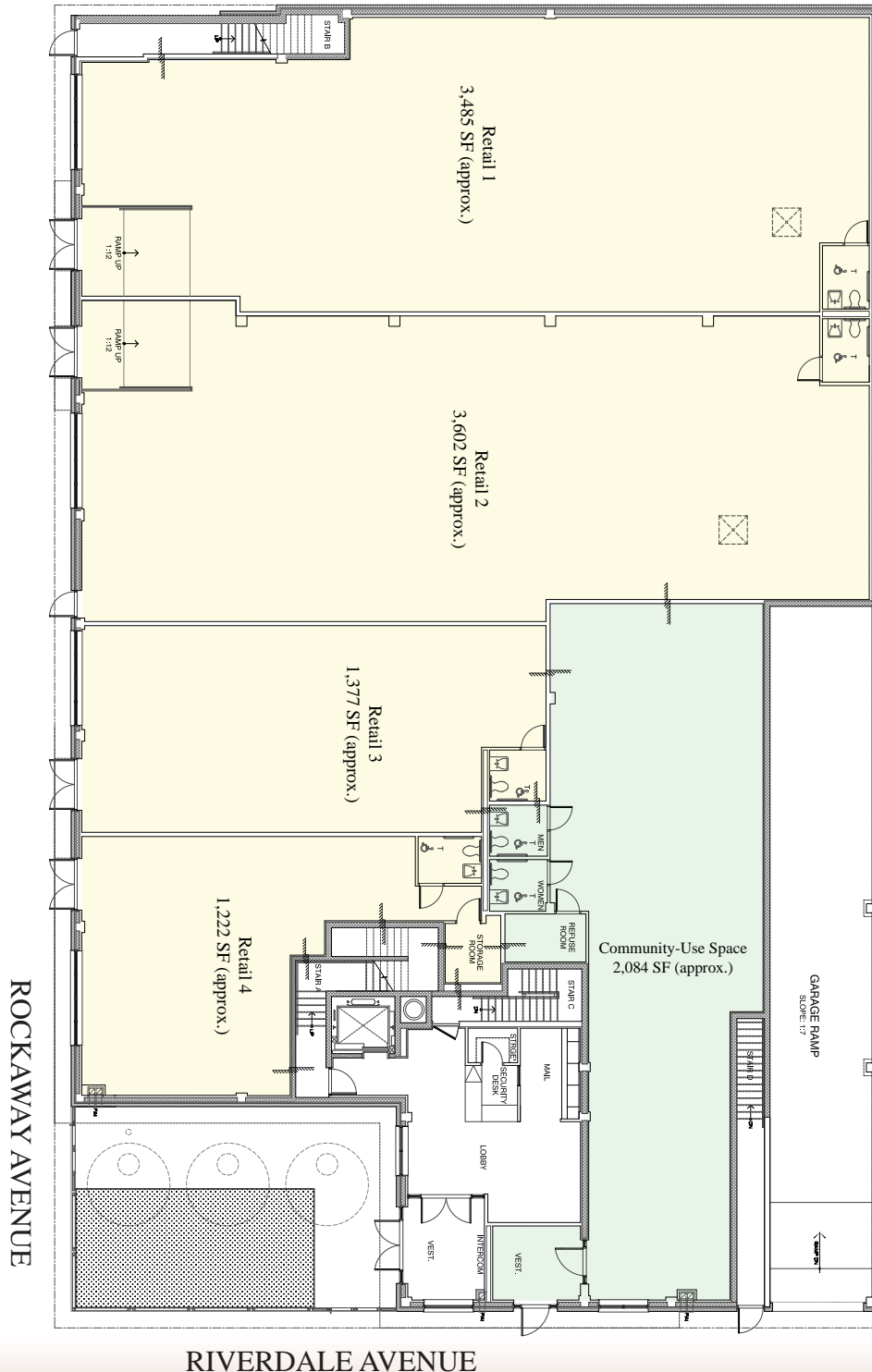

CPEX Real Estate | 350 Livingston Street, 1st Fl, Brooklyn NY 11217 | Tel: (718) 935-1800 | Fax: (718) 935-1822

All information contained herein was provided by or obtained from the owner of the property or from sources that we deem reliable. Though we have no reason to doubt the validity of the information, we do not warrant any information disclosed. All measurements of area and dimensions, zoning and uses must be independently verified. IT IS STRONGLY URGED THAT THE PROSPECTIVE TENANT CAREFULLY VERIFY EACH ITEM OF SIZE, RE TAXES, PERMITTED LEGAL USE AND ALL OTHER INFORMATION HEREIN.