

157 Beacon Lane – For Sale

Jupiter, Florida 33469

Residential/Development Opportunity



Location: 157 Beacon Lane Jupiter, Florida 33469
ID: 32-43-40-31-01-000-1570
Legal Description: Jupiter Inlet Colony Lt 157
Type: Residential
Beds/Baths/Garage: 3/2/2
Livable Sq Ft: 1,551 (Approx.)
Gross Sq Ft : 2,257 (Approx.)
Lot Dimensions: 85.0 x 114.0 (Approx.)
Lot Size: 9,690 (Approx.)
Construction: Concrete
Yearly Maintenance: \$20 (Approx.)
Assessment(08): \$714,137 (Approx.)
Taxes(08): \$12,970 (Approx.)



Front exterior



Rear exterior

Property Summary:

- Located in sought after Jupiter Inlet Colony on Jupiter Island, a quiet residential community spanning .2 square miles surrounded by the Atlantic Ocean, the Intracoastal waterway and Jupiter Inlet
- Community has 243 homes, private community clubhouse on Intracoastal, tennis courts, private police force, and marina
- Each home has access to public walking path that runs through the subdivision leading to the ocean on one end and the Intracoastal on the other
- Lowest priced property in subdivision
- Property is dated and in need of some repair
- Approximately 25 homes (10% of total) are currently on the market with asking prices ranging from \$700,000 – \$4,750,000
- 20 minutes from Palm Beach International Airport
- House sits on large lot with future development potential
- Short drive to both I95 and Florida's Turnpike at Indiantown Road

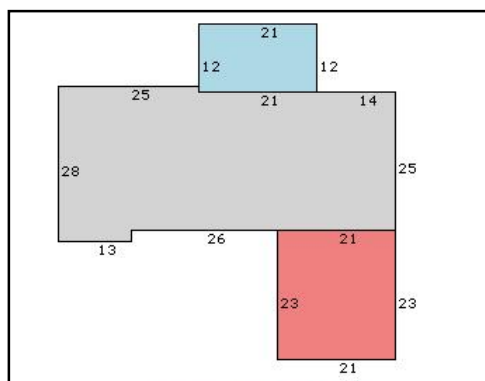

Floor Plan/Measurements

Sale Price: \$525,000

For Further Information, Please Contact Exclusive Sales Team:

Adam Rosenfield
Managing Director – Investment Sales
arosenfield@cplexre.com

WWW.CPEXRE.COM

CPEX Real Estate | 224 Datura St, Suite 614 | West Palm Beach, FL 33401 | Tel: (561) 835-3707 | Fax: (561) 835-3706

All information contained herein was provided by or obtained from the owner of the property or from sources that we deem reliable. Though we have no reason to doubt the validity of the information, we do not warrant any information disclosed. All measurements of area and dimensions, zoning and uses must be immediately verified. IT IS STRONGLY URGED THAT THE PROSPECTIVE PURCHASER CAREFULLY VERIFY EACH ITEM OF SIZE, EXPENSES, RENT ROLLS, PERMITTED LEGAL USE AND ALL OTHER INFORMATION HEREIN.

157 Beacon Lane – For Sale
Jupiter, Florida 33469
Residential/Development Opportunity

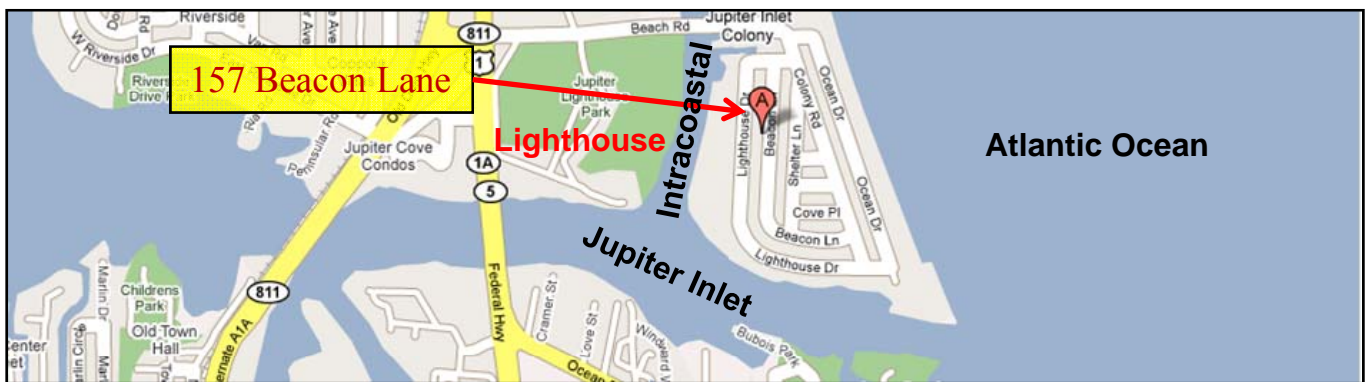

For Further Information, Please Contact Exclusive Sales Team:

Adam Rosenfield
Managing Director – Investment Sales
arosenfield@cplexre.com

WWW.CPEXRE.COM

CPEX Real Estate | 224 Datura St, Suite 614 | West Palm Beach, FL 33401 | Tel: (561) 835-3707 | Fax: (561) 835-3706

All information contained herein was provided by or obtained from the owner of the property or from sources that we deem reliable. Though we have no reason to doubt the validity of the information, we do not warrant any information disclosed. All measurements of area and dimensions, zoning and uses must be immediately verified. IT IS STRONGLY URGED THAT THE PROSPECTIVE PURCHASER CAREFULLY VERIFY EACH ITEM OF SIZE, EXPENSES, RENT ROLLS, PERMITTED LEGAL USE AND ALL OTHER INFORMATION HEREIN.